



Installation Manual

Premium Tension Compact In-Ceiling /
Premium EM Compact In-Ceiling

INTRODUCTION



This manual is an integral part of the product and must be read and understood in all its parts for safety reasons. It contains norms and directions for Correct and safe use of the screen. The manual should never be separated from the product; it must be stored in a suitable place to ensure its integrity, and in such a way as to be easily consulted by authorized personnel. Product user shall be responsible for the manual's safekeeping. User shall also be responsible for checking the screen's functionality and for the repair or replacement of any damaged parts that could pose a hazard. Images contained in this manual are intended to provide a detailed description of the product's functions, characteristics and procedures. Any slight difference, depending on the model represented, will not change the meaning that the images convey.

GENERAL CHARACTERISTICS OF THE PRODUCT

Our screens are manufactured in compliance with the following EC directives: 2006-95-EC low voltage directive (LVD), 2004-108-EC electromagnetic compatibility (EMC), 1999-05-EC radio equipment and telecommunication terminals (R&TTE).

The projection screen is a cadmium-free plastic pvc sheet, with M1 and M2 fire classification under French standards (LNE Laboratoire national de métrologie et essais - SME Centre de recherches du Bouchet). In the absence of a standardization at a European level of the various national classification norms, it should be noted that the French M1 class corresponds to non flammable material and that M2 class corresponds to flame retardant material.

UNPACKING THE SCREEN

Ensure that the screen has suffered no damage during transport. Promptly report any anomaly to the vendor. Verify that all screen accessories have been included (see list below). **WARNING** do not use cutters or sharp objects to open the wrapping.



- (2) n°8 threaded bars M8
- (3) n°4 Spacer nuts M8x30
- (4) n°4 Washers
- (5) n°4 Nuts M8
- (6) n°4 Thread stops M8
- (7) n°4 Base plates M8
- (8) n°2 Ceiling plugs
- (9) n°1 Plastic hex wrench
- (10) n° 1 unipolar selector switch
- (11) n° 1 RF transmitter (for integrated radio screen models)
- n°1 instructions booklet

(screws and plugs for wall mount are not included)

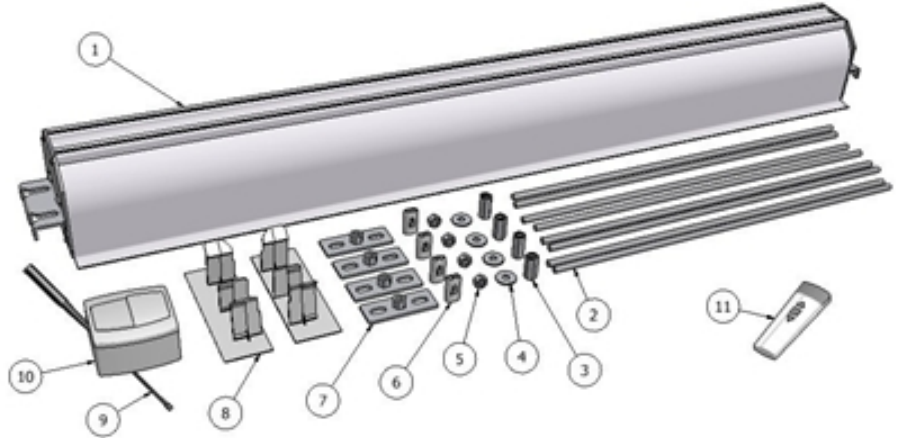

GENERAL SAFETY NORMS



- Always read the instructions and warnings set out in this manual very carefully before using the product or before performing any maintenance interventions.
 - Before and during use, check that the screen poses no risk of hazard.
 - Do not tamper with, remove or damage any part or component of the screen.
 - Never perform screen maintenance operations when the motor is on (for maximum safety, remove power supply).
- All our screens are covered by guarantee; validity of the same shall be subject to user's full compliance with the instructions contained in this manual.



WARNING: Faulty installation may compromise the safety of the product's operators; manufacturer shall not be held liable for damages to persons or things resulting from faulty installation, improper use, insufficient or inadequate maintenance of the screen.

Manufacturer shall not be held responsible for problems associated with installation errors.

Screen installation, electrical connections and verifications in case of malfunction of motorized rolling screens must be performed by authorized vendor or by personnel that is informed and trained in electrical hazards. The connection cable cannot be replaced. If the cable is damaged the screen must be replaced. Tampering with end stops or piercing the seal placed over holes shall entail the forfeiture of the guarantee. For any necessary clarifications please contact our technical office.

N.B. ONCE THE SCREEN HAS BEEN MOUNTED ON THE BRACKES, AND PRIOR TO USING IT, USER IS MANDATORILY REQUIRED TO ENSURE THAT THE SCREEN'S POSITION IS PERFECTLY HORIZONTAL.

WARNINGS AND RECOMMENDATIONS FOR CORRECT USE



Our screens are suitable for indoor use at normal temperature (20 - 25 °C) and humidity conditions. Special precautions are necessary for outdoor use, especially as regards temperature levels and the presence of dust. Exposure to temperatures of over 50 °C can cause permanent deformation of the screen's flatness, or the screen to come away from the roller.

Avoid prolonged exposure of the projection screen to solar light to prevent yellowing of the same (ensure that exposure to solar light does not cause the screen to reach said temperature level).

Since electrostatic charge tends to accumulate on the projection screen (which is made of PVC), attracting dust, excessive dustiness in the projection environment can deteriorate the optical quality of the screen (see projection screen cleaning instructions).

WARNING: Do not manually force the screens unrolling; this could result in the motor being damaged or the screen's case to come away from the wall mount brackets.

Do not allow children to play with the screen's control panel. Keep remote control out of children's reach.

Monitor screen movement and allow no-one near it until it is completely closed.

The following operations: blocking, preventing or forcing the screen's movement, hanging or swinging from it, adding or applying any object to the screen or backdrop, modifying the screen's structure - are strictly forbidden and could result in damages to the screen's rolling system and ensuing hazard to persons and things.

CLEANING AND MAINTENANCE

Remove dust from the case with a soft, clean cloth and a non aggressive detergent as necessary.

Clean the projection screen with a soft, clean, damp cloth, and a neutral or alcohol-base detergent as necessary. Since rubbing the screen with a cloth during cleaning operations can cause electrostatic charge to accumulate, we recommend the subsequent application of an antistatic liquid with a clean cloth, to avoid dust being attracted again. Periodically check the mounting system and electrical connections.

INSTALLATION INSTRUCTIONS

Fig. da 1
a 11

1. Prepare a hole for the screen as described in Fig. 1.
2. Install brackets as described in Fig. 2, adhering to distances given in Fig. 1.
3. Install screen as described in Fig. 3 to 7 of next page.
5. Finish installation by applying plugs as per Fig. 10 and 11.

WARNING: When installing the screen use plugs and screws suitable for the screen's weight and for the type of wall or ceiling on which the mount brackets are to be fixed, based on the following criteria:

Screen width up to cm	160	200	250	300	360	410	520	620
Overall weight	Ka 20	Ka 25	Ka 30	Ka 35	Ka 45	Ka 50	Kc 100	Kc 150



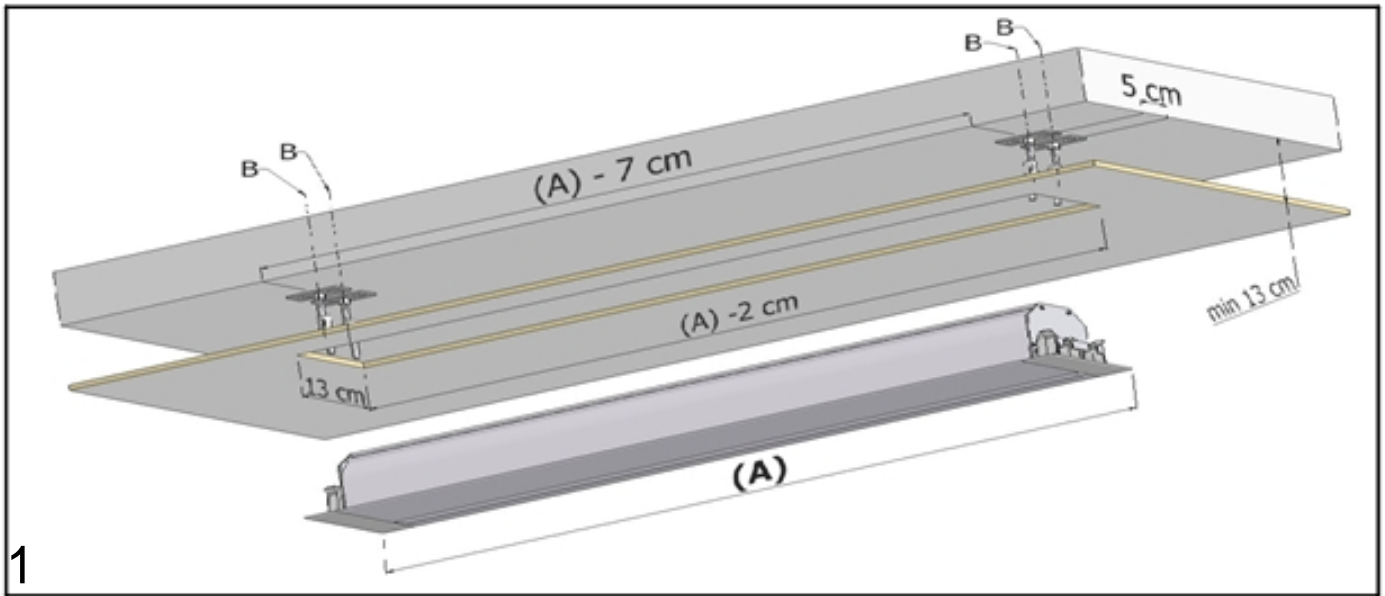

MOTORISED VARIANT ROLLER SCREENS

Technical characteristics:

Voltage: 230V
 Frequency: ~Hz50
 Power: 120W
 Torque: 8Nm
 Speed: 17Rpm
 Max nr. of cycles: 2
 Cable length: 3mt
 Mechanical strength:
 EN14202 conformant
 Operating T°:
 from -20 to +55 °C



FIG. 12



ELECTRICAL CONNECTION: electric cabling must be conformant with applicable IEC standards. IEC norm EN 60335-1 requires that supply network be fitted with an omnipolar selector switch with contact opening distance of at least 3 mm. For the screen's control use only the selector switch provided by manufacturer, or equivalent model, and follow the instructions of the connection diagram shown on Fig. 12 (if the motor is mounted on the left, the colours of the wires must be inverted, i.e. descending = brown, ascending = black). The selector switch must be mounted within sight distance of the product, at a 1.5 - 1.8 m height from the floor.

WARNING: Correctly performed, state-of-the-art, norm-compliant electrical connections are important to prevent accidents and to ensure the screen's optimal and unaltered performance in time. Prior to carrying out any operation on electrical parts ensure that power supply is disconnected. In screens fitted with cases the motor is positioned on the right hand side of the screen as seen from the front (upon request it can be located on the left). Never connect two or more motors to the same selector switch without a control unit or two switches to the same motor.

END STOP ADJUSTMENT FOR MOTORISED VARIANT ROLLER SCREENS



WARNING - READ CAREFULLY BEFORE PERFORMING ADJUSTMENTS

Adjustments shown on Fig. 8 must be performed by authorised and specialized personnel only. Incorrect performance of the procedures described may result in damages to the product which will not be covered by guarantee. End stops adjustment varies depending on the motor's position (right or left side) or on drop of the curtain (front or rear); the diagram on Fig. 8 is sectioned based on these variants. Adjustment is performed with a 4 mm hex wrench (included).

END STOPS ADJUSTMENT SCREWS ARE POSITIONED IN THE BOTTOM PART OF THE SCREEN AND COVERED BY A WHITE STICKER OR WITH THE WORDING "SEAL OF GUARANTEE". DO NOT ADJUST THE END STOPS WHEN UP OR DOWN BUTTON IS ACTIVATED.

WARNING

End stop is adjusted so as to allow the projection sheet to wind around the roller at least 1.5 times to avoid the sheet coming loose. Special attention must be paid when end stops are adjusted in such a way that projection sheet unwinds beyond the factory setting. This is allowed within a limit of 3 cm without posing a risk to the product. Incorrect adjustment of end stops can cause:

- Projection sheet coming away from the roller
- Projection sheet winding the wrong way, with ensuing damage to flatness of the projection surface and to winding mechanisms
- Breaking of bottom end black frame welding (framed screens)
- Excessive strain on motor with possible ensuing damage and activation of motor's thermal resistance
- Excessive winding of the end stop adjustment system with ensuing breaking of the mechanical part

GUARANTEE

Operators are reminded that in cases where seals have been tampered with and where any damages have resulted from incorrect adjustment, repair interventions shall not be covered by guarantee.



SCREENS WITH "MOTORISED INTEGRATED RADIO" ROLLER SYSTEM

Technical characteristics:

Voltage: 230V
 Frequency: ~Hz50
 Power: 120W
 Torque: 8Nm
 Speed: 17Rpm
 Max nr. of cycles: 2
 Cable length: 3mt
 Mechanical strength:
 EN14202 conformant
 Operating T°:
 from -20 to +55 °C
 Frequency: 433.92 MHz
 Trans. range: 150mt



FIG. 13



ELECTRICAL CONNECTION: electric cabling must be conformant with applicable IEC standards. IEC norm EN 60335-1 requires that supply network be fitted with an omnipolar selector switch with contact opening distance of at least 3 mm. Operates with standard radio control (supplied). Follow instructions provided in connection diagram on Fig. 13.

WARNING: Correctly performed, state-of-the-art, norm-compliant electrical connections are important to prevent accidents and to ensure the screen's optimal and unaltered performance in time. Prior to carrying out any operation on electrical parts ensure that power supply is disconnected. In screens fitted with cases the motor is positioned on the right hand side of the screen as seen from the front (upon request it can be located on the left).

END STOP ADJUSTMENT FOR SCREENS WITH "INTEGRATED RADIO MOTORISED" ROLLER SYSTEM



WARNING - READ CAREFULLY BEFORE PERFORMING ADJUSTMENTS

Adjustments illustrated below must be performed by authorized and specialized personnel only. Incorrect performance of the procedures described may result in damages to the product which will not be covered by guarantee.

WARNING

End stop is adjusted so as to allow the projection sheet to wind around the roller at least 1.5 times to avoid the sheet coming loose. Special attention must be paid when end stops are adjusted in such a way that projection sheet unwinds beyond the factory setting. This is allowed within a limit of 3 cm without posing a risk to the product. Incorrect adjustment of end stops can cause:

- Projection sheet coming away from the roller
- Projection sheet winding the wrong way, with ensuing damage to flatness of the projection surface and to winding mechanisms
- Breaking of bottom end black frame welding (framed screens)
- Excessive strain on motor with possible ensuing damage and activation of motor's thermal resistance
- Excessive winding of the end stop adjustment system with ensuing breaking of the mechanical part

GUARANTEE

Operators are reminded that in cases where seals have been tampered with and where any damages have resulted from incorrect adjustment, repair interventions shall not be covered by guarantee.



MEMORISING THE "FIRST" TRANSMITTER ON SCREEN

Caution! - DO NOT follow this procedure if Transmitters have already been memorized on screen.

01. Turn on the power to screen: the motor makes 2 LONG motions (= no transmitters memorized).

02. (Within the next 5 seconds) Press and hold down key on the transmitter for about 3 seconds and release it as soon as the motor start the first of 3 LONG motions (= memorization complete).

Caution! - Once this part of programming has been completed, the Up and Down movements of the motor are still not associated to keys and on the Transmitter. This will take place automatically during one of the three programming procedures of limit switches "0" and "1".

PROGRAMMING OF LIMIT SWITCH POSITIONS upper "0" and lower "1"

01. Press and hold down key (or) on the transmitter until the roller shutter/awning reaches the "0" position required by the user; then release the key.

ATTENTION!!! the correct "0" position is when the low bar of the screen is positioned at 2 mm from the case.

02. Press and hold down key until the motor performs 1 VIBRATION; then release the key.

03. Press and hold down key again (for approx. 5 seconds), until the motor performs 4 SHORT motions; then release the key.

04. Press and hold down key until the motor performs 2 LONG motions (= the "0" position is memorized); then release the key.

05. Press and hold down key (or) until the roller shutter/awning reaches the position "1" required by the user; then release the key.

06. Press and hold down key until the motor performs 1 VIBRATION; then release the key.

07. Press and hold down key again (for approx. 5 seconds), until the motor performs 4 SHORT motions; then release the key.

08. Press and hold down key until the motor performs 2 LONG motions (=position "1" is memorized); then release the key.

Note - Once this programming procedure is complete, key on the Transmitter will control the Up manoeuvre of the roller shutter/awning, while key will control the Down manoeuvre. The roller shutter/awning will stop at programmed positions "0" and "1" during each of these manoeuvres.

REPOSITIONING OF LIMIT SWITCH lower "1"

01. Press and hold down key (for approx. 5 seconds), until the motor performs 1 VIBRATION, then release the key.

02. Press and hold down keys and simultaneously (for approx. 5 seconds), until the motor starts to automatically move the roller shutter / awning into position "1", then release the keys.

03. (within the next 5 seconds) Press key and point to the roller shutter/awning in the new position "1".

04. (within the next 4 seconds) Press and hold down keys and simultaneously until the motor performs 2 LONG motions (= new position "1" memorized), then release the keys

DELETING TRANSMITTERS FROM THE MEMORY

Caution! - This procedure deletes all memorized transmitter codes from screen memory. The procedure can be performed both with a memorized transmitter as well as a non memorized transmitter.

If the transmitter is memorized, proceed as follows:

01. Press and hold down key (for approx. 5 seconds), until the motor performs 1 VIBRATION; then release the key.

02. Press and hold down key until the motor performs 3 LONG motions; then release the key exactly on the third movement.

03. Press and hold down key until the motor performs 3 LONG motions; then release the key exactly on the third movement.

04. Press and hold down key until the motor performs 3 LONG motions; then release the key exactly on the third movement. After a few seconds the motor performs 5 LONG motions (= all transmitters deleted).

If the Transmitter is not memorized, proceed as follows:

A. Disconnect from power supply (if connected) and connect again the tubular motor to the power supply. Within the next 60 seconds, press and hold down key (for approx. 5 seconds), until the motor performs 1 VIBRATION; then release the key.

B. (within the next 5 seconds) Disconnect from the power supply.

C. Power the motor again: the previous procedure, from point 01 to point 04, must be performed within 60 seconds from turning on the power supply.

TROUBLESHOOTING

ANOMALY	POSSIBLE CAUSE	REMEDIAL ACTION
Screen does not open/close	Not connected to power supply	Check electrical connection
Screen does not open/close	The motor's thermal protection is activated A	Allow to cool down for about 10 minutes
Screen moves in one direction only Screen has come down but will not go up R.I. screen is blocked	power supply cable has not been connected End stop has been incorrectly modified Remote control batteries are flat	Check connection to selector switch Call vendor or a technician for assistance Replace batteries

PRODUCT'S DISPOSAL



As is the case for installation procedures, when the product reaches the end of its useful life, disposal operations must be carried out by qualified personnel.

The product is made up of various types of material: some can be recycled, others have to be disposed of. You must follow applicable recycling or disposal regulations in force in your area for this product category.

As shown in the picture on the left, you must not throw the product into a domestic litter bin. Either dispose of the various components separately, pursuant to the regulations applicable in your territory, or hand the product over to a vendor upon purchasing a similar new product.

Warning: local regulations can foresee heavy fines in case of unlawful disposal of this product.

SCREEN GUARANTEE



Screens are covered by a 24 month guarantee for projection curtains, mechanical and structural parts, motors installed on single products.

The guarantee's validity starts from the date of purchase on the part of the end user; such purchase date must be documented by a purchase receipt when requesting technical interventions or replacement.

The guarantee covers damages and malfunctions resulting from normal use of the products, and replacement free of charge of components with manufacturing flaws; the service includes collection/delivery by a contracting courier at the manufacturer's expense (only for Italy and Poland guarantees).

The guarantee is forfeited in case of incorrect use or installation, tampering or repair on the part of personnel not authorized by manufacturer or tampering with the seal for end stop adjustment, which can only be carried out by technicians or specialized personnel. The guarantee does not cover damages resulting from normal wear and tear or from particular weather or environmental conditions. Damages to goods during transport or handling operations are not covered by guarantee.

Goods must therefore be checked carefully upon receive.

Screens returned for repair will not be accepted unless they are accompanied by the manufacturer's RMA (return material authorization) and adequately packed.

Manufacturer reserves the right to verify the existence of the requisites for the validity of the guarantee.

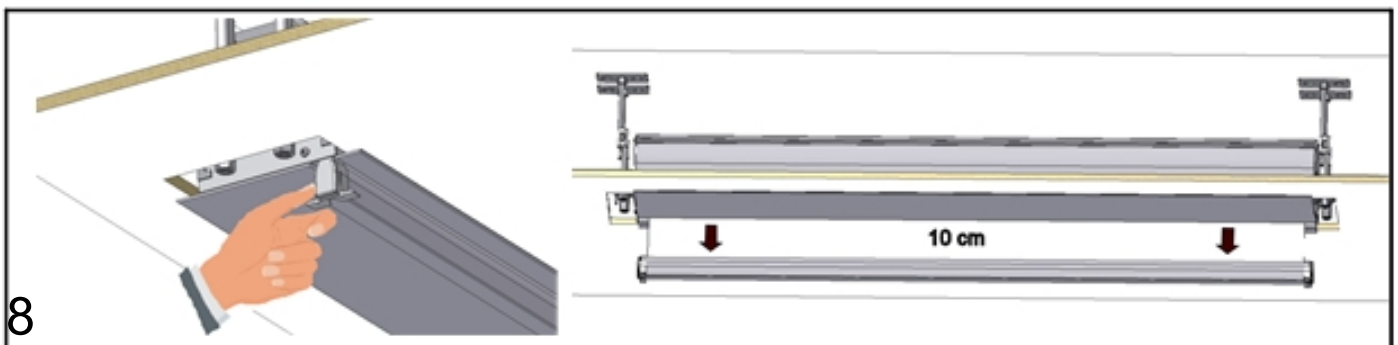
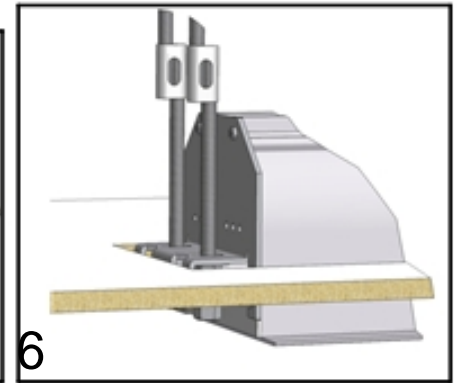
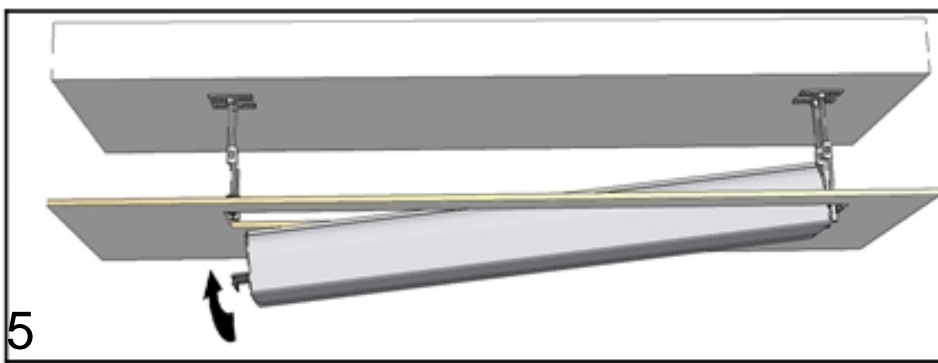
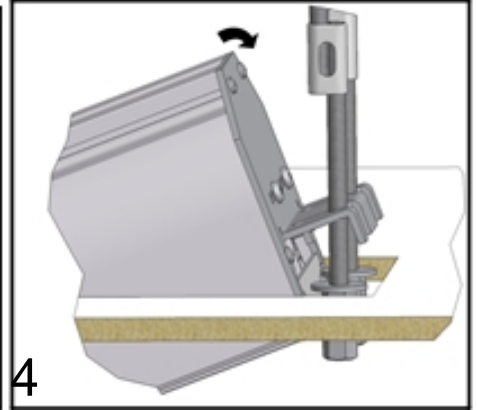
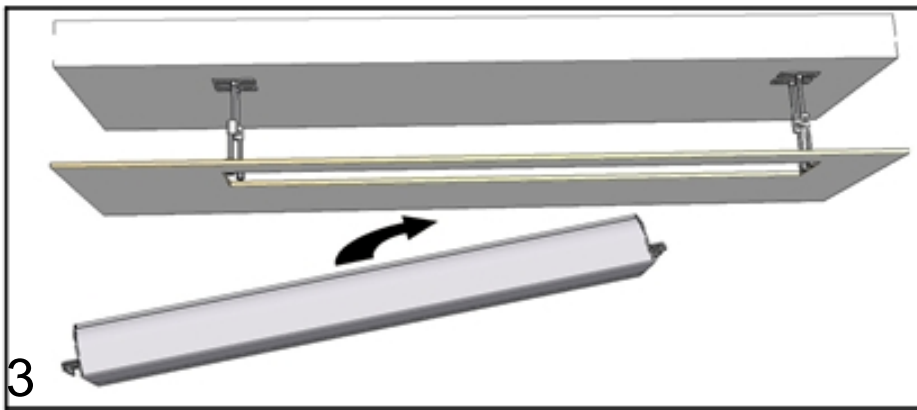
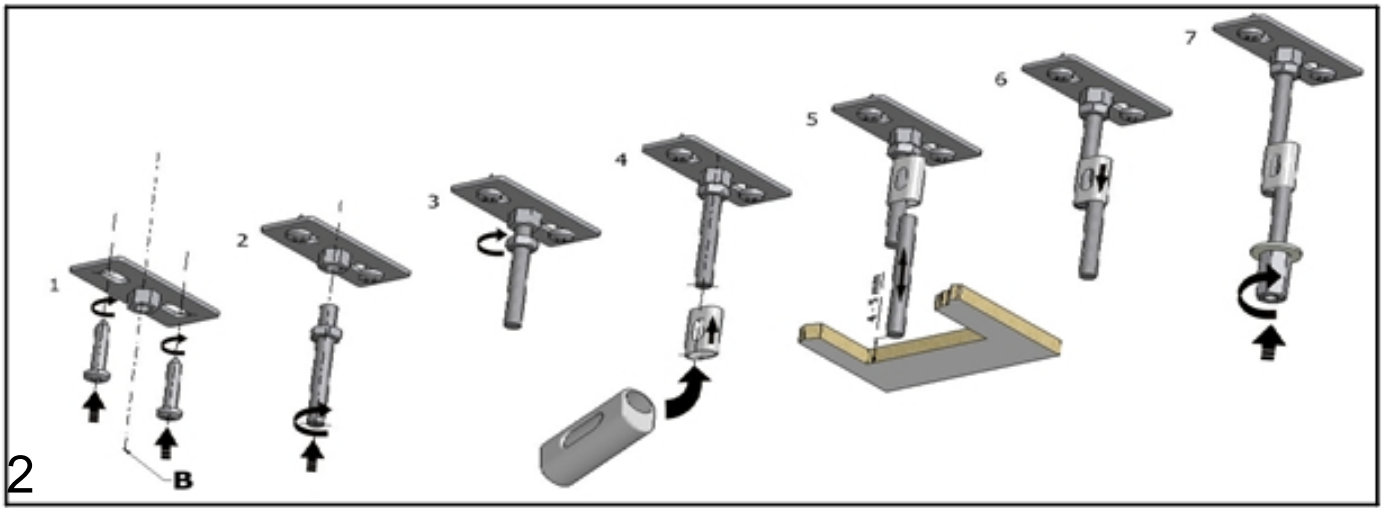

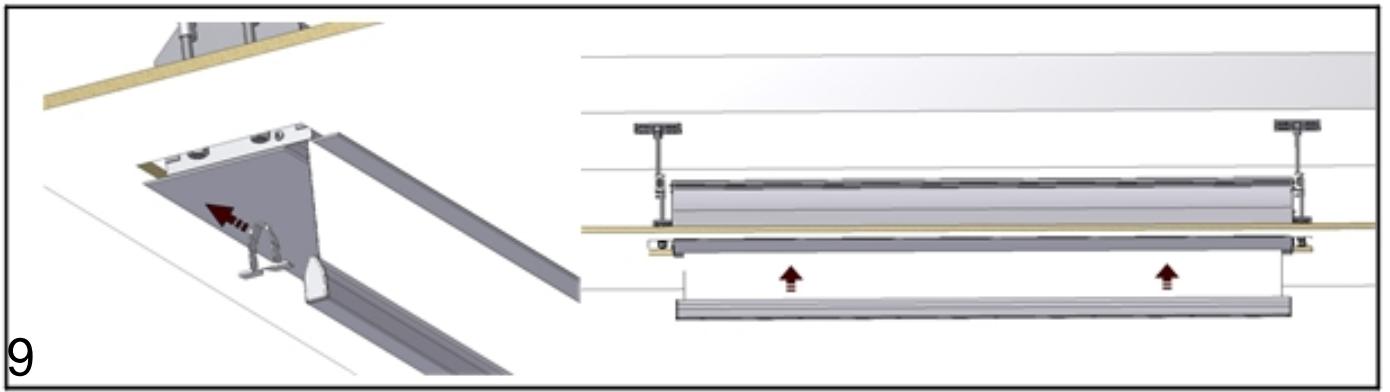

9

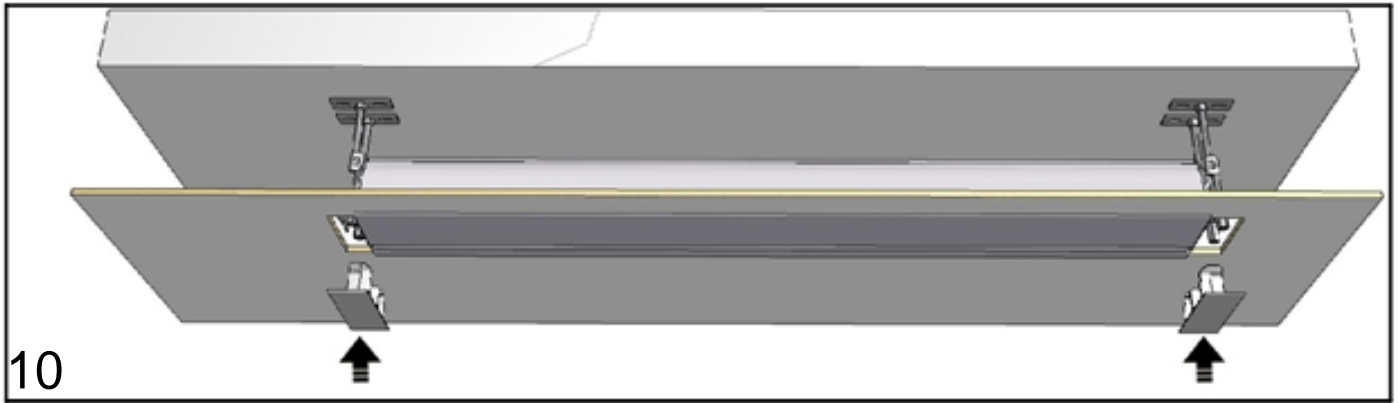

10



11

12



Linea
Power supply
Alimentation
Versorgung
Alimentación
Źródło zasilania
230V 50 Hz

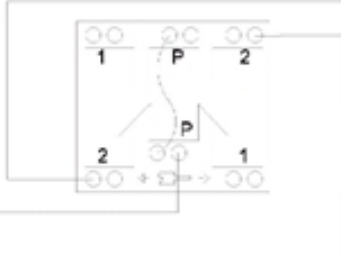

Motore SALITA
Brown UP
Moton ACENTE
Brujn ALPWARDS
Moton SUBIDA
Bngajoy GORA

Motor DISCIDA
Black DOWN
Moto DISCENTE
Schwarz ALFWARDS
Negro SUBIDA
Cratly DO

Siemens COMMON
Siemens COMMON
Siemens COMMON
Amd COMMON
Nobreak VISPOLNY

Gelb Verde TERRE
Yellow Green EARTH
Jaune Vert TERRE
Gelb Grün ERDE
Amarillo Verde TERRE
Zółto-Zielony LUDZIWIENE

Schermo
Motorizzato
Motorized
Screen
Ecrans
Motorise'
Elektrischer
Leinwand
Pantallas
Motorizada
Ekran z napędem
elektrycznym

13



Linea
Power supply
Alimentation
Versorgung
Alimentación
Źródło zasilania
230V 50 Hz



Motore FASE
Brown PHASE
Moton PHASE
Brujn PHASE
Moton FASE
Bngajoy FADA

Siemens NEUTRO
Siemens NEUTRAL
Siemens NEUTRE
Siemens NULLELEK
Amd NEUTRO
Nobreak NEUTRALNY

Gelb Verde TERRE
Yellow Green EARTH
Jaune Vert TERRE
Gelb Grün ERDE
Amarillo Verde TERRE
Zółto-Zielony LUDZIWIENE

Schermo
R.I. Motorizzato
R.I. Motorized
Screen
Ecrans
R.I. Motorise'
R.I. Elektrischer
Leinwand
Pantallas
R.I. Motorizada
Ekran z napędem
elektrycznym
zdalnie sterowany

FIG. 8

BACK FALL OF CURTAIN

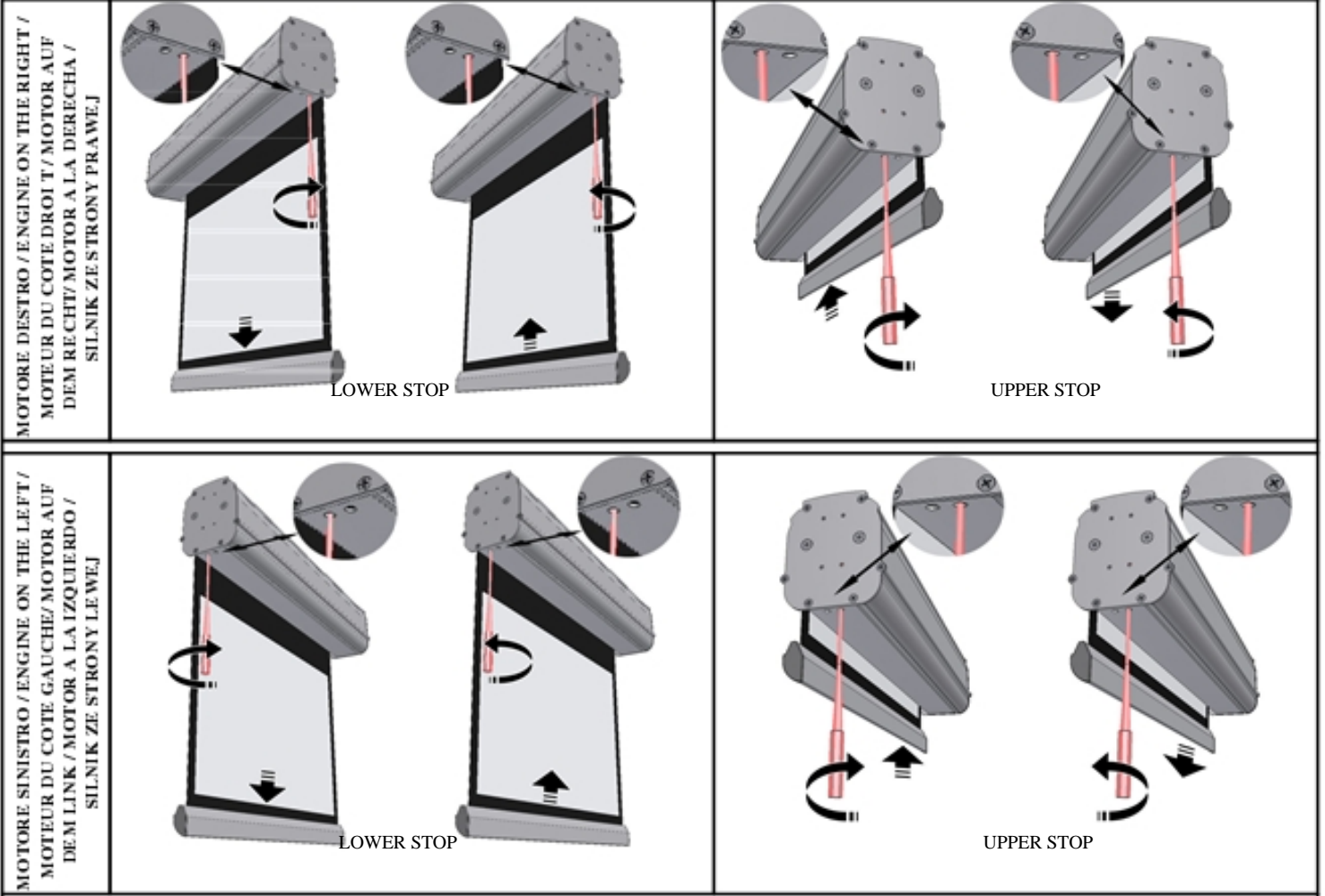

FIG. 8

FRONTAL FALL OF CURTAIN

